

Accessories

OPERATOR

The OPERATOR welding helmet with auto-darkening filter (ADF) is ideal for welders where safety comes first. The OPERATOR is up for the job and is sold in different variants prepared for all welding applications:

- Standard ADF helmet
- Air-fed helmet prepared to be fitted with fresh-air unit
- Air-fed helmet with Powered Air Purifying (PAPR) unit

The level of comfort is high, and the OPERATOR can be fitted according to your needs. The built-in LCD control panel is easy to adjust, and the large ADF viewing area provides the optimum working conditions. The helmet can quickly be adjusted in the right position and has a 5 strap headgear to help distribute the weight, whilst allowing for maximum stability.

The Powered Air Purifying Respirator (PAPR) unit has a filter efficiency of 99.997%, and the air flow is easy to adjust with one button function. The unit can work under extreme conditions (from -5 to 55°C) and has a battery duration of up to 9h at low speed. The unit is delivered with an extremely light weight flexible quick connect hose supplied with FR hose cover, so movability is kept at maximum.

Operator features:

- Large ADF viewing area (107mm x 75mm) and side windows for extended peripheral view. Blocking panels included with helmet
- LCD control panel (5-13 shade levels)
- Ergonomic comfort headgear
- External grind button
- Efficient PAPR unit available with one button function
- True Colour ADF technology

Fields of application:

- MMA (electrode)
- MIG/MAG
- TIG
- GRINDING

High impact resistance
EN175B rated for grinding

External grind button
Quick change between welding and grinding

Large viewing area ADF
107mm x 75mm
(4.21" x 2.95")

Side windows
For extended peripheral view. Blocking panels included with helmet

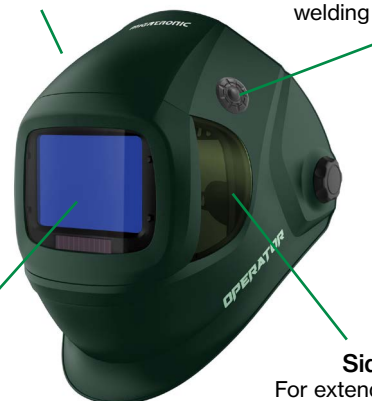

Technical data:

- Auto-darkening filter 750MG (ADF)
- Variable shade control DIN setting 5-8 (cut mode) and 9-13 (welding mode)
- Adjustable sensitivity ensures optimal response to varying welding conditions, enhancing safety and precision
- Delay control to adjust the time for the lens to switch to clear state after welding or cutting (0.1-1.0 s)
- 4 arc sensors
- Classification: 1/1/1
- PAPR includes PAPR unit equipped with P3 filter and pre-filter, a blower, filtration unit, breathing tube assembly, battery, shoulder strap and belt: (air flow from 170 +lpm to 210 +lpm)
- OPERATOR Standard approved according to CE EN379, CE EN175/166
- OPERATOR with PAPR unit approved according to CE EN379, CE EN175/166, CE EN12941 TH3P.



MIGATRONIC



OPERATOR helmet standard



OPERATOR helmet air-fed

Pos.	Art.no.	Description
A	82910101	OPERATOR helmet STD (Midnight Black)
B	82910102	OPERATOR helmet STD (Nordic Pine)

Pos.	Art.no.	Description
A	82910103	OPERATOR helmet (Midnight Black air-fed)
B	82910104	OPERATOR helmet (Nordic Pine air-fed)

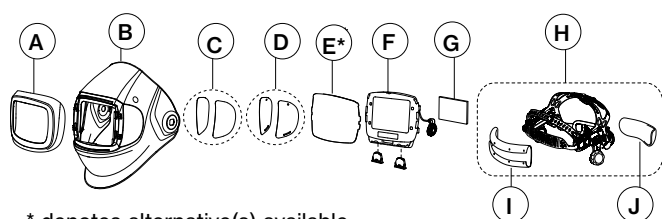

* denotes alternative(s) available

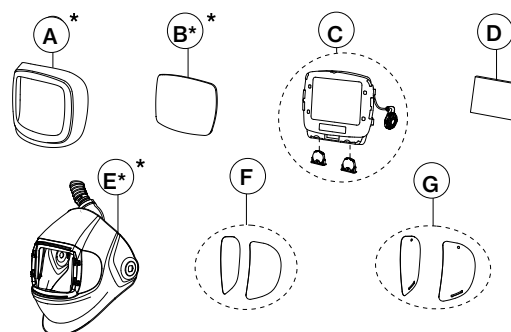

* denotes alternative(s) available

Pos.	Art.no.	Description
A	82901401	Front lens frame (Midnight Black)
	82901406	Front lens frame (Nordic Pine)
B	82901501	Shell standard (Midnight Black)
	82901508	Shell standard (Nordic Pine)
C	82901403	Side lens
D	82901402	Side lens cover
E*	82901101	Front cover lens 160.36x107.3x1.2mm
	82901102	Front cover lens HD 160.36x107.3x1.2mm
	82901103	Front cover lens anti-scratch 160.36x107.3x1.2mm
F	82901301	Auto darkening filter (750MG)
G	82901104	Inside cover lens (107x80x1.0mm)
H	82901503	Headgear
I	82901505	Sweatband
J	82901506	Soft pad rear sweatband

Pos.	Art.no.	Description
A	82901401	Front lens frame (Midnight Black)
	82901406	Front lens frame (Nordic Pine)
B*	82901101	Front cover lens (160.36x107.3x1.2mm)
	82901102	Front cover lens HD 160.36x107.3x1.2mm
	82901103	Front cover lens anti-scratch 160.36x107.3x1.2mm
C	82901301	Auto darkening filter (750MG)
D	82901104	Inside cover lens (107x80x1.0mm)
E	82901502	Shell with Air duct (air-fed) (Midnight Black)
	82901509	Shell with Air duct (air-fed) (Nordic Pine)
F	82901403	Side lens
G	82901402	Side lens cover

Art.no.	Description
82901404	Extended hood protection
82901405	Extended neck protection

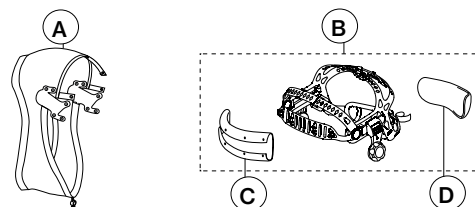

Marking	Art.no.	Colour code	Protection against
P (R SL)	82902101	White	Particulates (R=reusable, SL=test against sodium chloride and paraffin oil)
A1B1E1K1	82902105	Brown/ Grey/ Yellow/ Green	Organic gases / Inorganic gases / Sulfur dioxide, acidic gases / Ammonia and organic ammonia derivatives
A1B1E1	82902107	Brown/ Grey/Yellow	Organic gases / Inorganic gases / Sulfur dioxide, acidic gases
A2	82902106	Brown	Organic gas and vapor, boiling point > 65°C

Pos.	Art.no.	Description
A	82901507	Face seal
B	82901504	Headgear (airfed)
C	82901505	Sweatband
D	82901506	Soft pad rear sweatband

Accessories **OPERATOR**



OPERATOR helmet with PAPR

Pos.	Art.no.	Description
A	82920101	OPERATOR helmet with PAPR kit (Midnight Black)
B	82920102	OPERATOR helmet with PAPR kit (Nordic Pine)

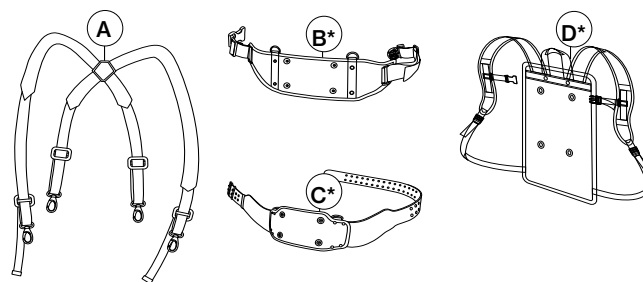

* denotes alternative(s) available

Pos.	Art.no.	Description
A	82902403	Air shoulder strap
B*	82902405	Air belt cushion (including screws&washers)
C*	82902404	Air heavy duty leather belt
D*	82902406	Air backpack harness

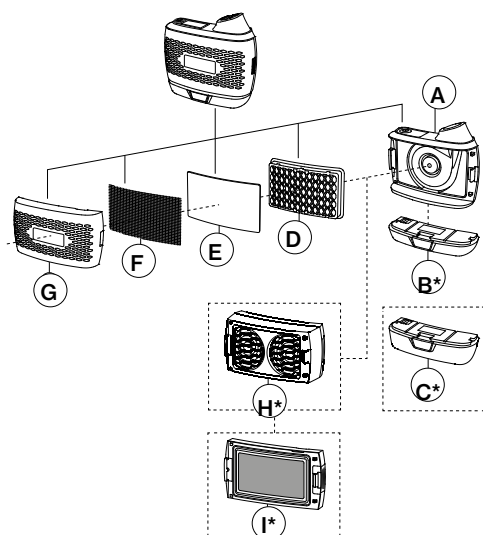

* denotes alternative(s) available

Pos.	Art.no.	Description
A	82902201	Air PAPR unit body
B*	82902202	Air fast-charging standard battery
C*	82902203	Air fast-charging heavy duty battery
D	82902101	Air P3 particle filter
E	82902102	Air pre-filter
F	82902104	Air spark screen
G	82902402	Air filter cover
H*	82902105	Air gas filter (A1B1E1K1)
	82902106	Air Gas filter (A2)
I	82902103	Air carbon Pre-filter

Pos.	Art.no.	Description
	82902408	Drawstring bag



Pos.	Art.no.	Description
A	82902407	Air flow indicator

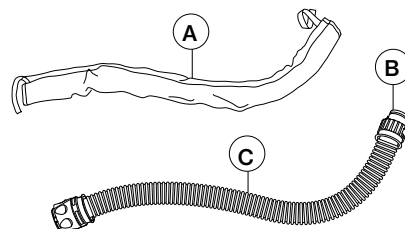

Pos.	Art.no.	Description
A	82902303	Air hose O connector cover
B	82902301	Air O ring
C	82902302	Air hose O connector (including --ring)
	82902306	Air hose holder ring

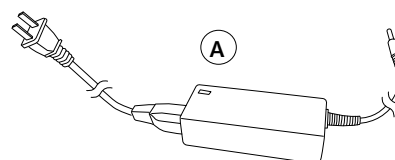

Pos.	Art.no.	Description
A	82902204	Fast-charging battery charger
	82902409	Multi-dock battery charger (UK)
	82902410	Multi-dock battery charger (EU)

Magnification lenses for OPERATOR welding helmet

Magnification lenses that suit the OPERATOR welding helmet with its large viewing area.

Art.no.	Strength	Size mm	No of pcs.
82901111	+1.0	55 x 110	1
82901112	+1.5	55 x 110	1
82901113	+2.0	55 x 110	1
82901114	+2.5	55 x 110	1
82901115	+2.75	55 x 110	1